

## Minutes of Board of Directors Meeting

Wed. August 8, 2018

On the Border, Northville, MI

### Attendees:

Frank Putman, Scott Harvey, Jennifer Glass, John Kytasty, Steve Balanecki, Cindy Wisner, Brian Thorpe, John Lisiecki, Aldo Parodi, John Fishbeck, Ken Wiedbusch, Matt Wolfe, Jon Trudeau.

Meeting called to order at 7:00pm.

### 1. Current and Online Business

- a. **July 2018 minutes** were not approved online. Once again, “yes” votes did not match “yes” posts. Motion to approve minutes, S. Harvey, 2<sup>nd</sup> Jen Glass, unanimously approved.
- b. **BOD Travel reimbursement** policies update in progress.
- c. **Web Master** – J. Lisiecki’s contact did not respond. Keith Armitage has someone interested and will follow up.
- d. **Budget Subcommittee** – KA and JK discussed. Need to communize budget process.
- e. **Thayer Automotive** – declined to give extra sponsorship money. Will maintain at \$1,200 and asked for total to be allocated to Rallycross. Thayer would like feedback on website hits, and how we market the sponsorship. There was discussion of increasing their visibility on Facebook, as well as possibly giving a free event entry to any member buying a car from Thayer. See Appendix 11 for further discussion. MW will follow up on web data.

### 2. Reports (including new/updated 2018 Event Budgets and follow up)

- a. **Race**
  - i. **No report**
- b. **Rallycross**
  - i. **Great Lakes Champ. Series (#7 & 8)**, July 28 & 29. I-96 Speedway. There were 61 entries, most of whom had a good time. The nearby pig farmer complained about the dust after a wind shift, but a course change reduced the dust. The new owner is happy to have us back in October and kept the rent at \$1,000.
  - ii. **Budget, Crystal August 25** (Appendix 1). Motion to approve, Brian Thorpe, 2<sup>nd</sup>, Matt Wolfe, unanimously approved.
  - iii. **Budget, I96 Speedway, October 6**, (Appendix 2). Motion to approve, Jen Glass, 2<sup>nd</sup>, Scott Harvey, unanimously approved.

- iv. **Budget, Oakshade Raceway, November 3 & 4**, (Appendix 3), This is a Divisional Rallycross, entries will not be capped. Motion to approve, Scott Harvey, 2<sup>nd</sup>, Cindy Wisner, unanimously approved.
- v. **Budget, Thistle Hill, December 1**, (Appendix 4), Motion to approve, John Kytasty, 2<sup>nd</sup>, Matt Wolfe, unanimously approved.
- c. **Autocross**
  - i. **After the Fireworks, July 13 -15. Oscoda.** Joint with SVR. 136 cars, good event.
  - ii. **Oscoda Pro Solo, August 3 - 5.** 220 cars entered.
  - iii. **Before Nationals, August 17 - 19.** Funmover not needed. It is still in Tawas.
  - iv. **Budget, Fall into Autumn, Schoolcraft, September 30.** (Appendix 5). Discussion: increase charity donation from \$7 to \$13 per car. This is the same as the insurance and sanction fees which are waived for a charity event. Motion to approve as amended, John Kytasty, 2<sup>nd</sup>, Jen Glass, unanimously approved.
  - v. **Budget, Season Ender, MIS October 13.** (Appendix 6). Will use infield road course. No porta potty needed. Motion to approve, Cindy Wisner, 2<sup>nd</sup>, Matt Wolfe, unanimously approved.
- d. **Rally**
  - i. **Moonlight Monte**, July 21, 15 cars entered. The four equipped cars had very close of 9, 13, 13, 14.
  - ii. **POR, September 8 & 9**, will go into the UP this year. This will be run as a one-day event and is shorter than previous years. The entry fee was raised from the anticipated \$100 to \$120 to cover extra fuel costs.
  - iii. **Budget, Pavement Ends, November 10**, (Appendix 7). Motion to approve, Scott Harvey, 2<sup>nd</sup>, Jen Glass, unanimously approved.
- e. **Asst. RE**
  - i. **Banquet** – first weekend in February 2019 should work. Looking for location suggestions. Possibilities include The Henry Ford.
- f. **RE**
  - i. **Round Table Discussion**, on Membership Retention. National Office asked Detroit, Houston and Texas Regions to participate. Frank Putman and Steve Balanecki will join in.
  - ii. **Safety Violation at the pro Solo event at Oscoda.** “Autocross Rules” 1.3.2.O state: “*Children under twelve (12) years of age and pets shall be prohibited in the staging, grid, start, finish, and course areas.*” This rule was violated at this event and suggested corrections were ignored more than once. In future, safety rule violations could be reason to shut down the event until safety is restored.
- g. **Treasurer**
  - i. **Cash** - We have approx. \$180k in the bank.
  - ii. **Work Load** is very high, and some extra help is needed. Jen Glass will discuss with Dan Assenmacher and report to the BOD.
- h. **Membership report**

- i. **We have 1447 members**, a decrease of 36; 16 new, 52 lost. Steve B. sent emails to the non-renewals with a few responses, mostly race people who are sitting out a season.
    - ii. **Service awards** – 13 were sent out.
  - i. **Equipment**
    - i. **Conquistador** will get new tire soon. AC quit. KW will get estimated to fix.
    - ii. **Fire Extinguishers**, need advice from Insurer.
    - iii. **Opioid Overdose**, how to identify, how to use Narcan nasal spray. (Appendix 8).
    - iv. **Flags**, will need new flags if Detroit GP runs next year.
  - j. **Open Exhaust**, next issue will be Summer 2018, at the end of August.
  - k. **Street Survival®**, **September 22**, need instructors.
  - l. **Website/Social media**, no recent success in finding a webmaster.
  - m. **Special Events**
    - i. **FSAE**, final budget will be available soon. Cooper Union is suing the SAE for damage to its car which tipped over while being towed. DRSCCA is not involved.  
**A Recap Meeting** was held to discuss the 2019 event, course etc.
    - ii. **Detroit Grand Prix**, Frank Putman sent a letter of support for continuation of the Detroit Grand Prix to the MI DNR. (Appendix 9). At a recent meeting for comments about the DGP, 400 people attended. Response was overwhelmingly supportive, with a few against. It looks likely that the event will take place in 2019.
    - iii. **Empire Hill Climb** – September 15. In progress
    - n. **Social events**. This year is the 70<sup>th</sup> anniversary of the Detroit Region. A special event, yet to be determined, will be held.
    - o. **Calendar Review** – discussed events planned over the next few months.
- 3. **New Business**  
None
- 4. **Next Meeting** – September 12, 2018 at On-the-Border at 7:00 pm
- 5. **Adjourn** 9:24pm

## Appendix 1 – Budget – Rallycross, Crystal, August 25, 2018

### DETROIT REGION SCCA EVENT BUDGET - RALLYCROSS

APR 1

|                            |                                  |                    |                    |                    |                   |
|----------------------------|----------------------------------|--------------------|--------------------|--------------------|-------------------|
| Event:                     | Rallycross #9 @ Crystal Speedway |                    | Event Date(s):     | August 25, 2018    |                   |
| Chairperson(s):            | Jon Jareo                        |                    | Website Info Sent: |                    |                   |
|                            | <b>Aug 2017</b>                  |                    | <b>This Year</b>   |                    | <b>This Year</b>  |
|                            | <b>Actual</b>                    |                    | <b>Budget</b>      |                    | <b>Actual</b>     |
| <b>INCOME</b>              |                                  |                    |                    |                    |                   |
| Entry fees:                |                                  |                    |                    |                    |                   |
| Member                     | 39 @ \$ 50.00                    | \$ 1,950.00        | 35 @ \$ 50.00      | \$ 1,750.00        | @ \$ 50.00 \$ -   |
| Non-member                 | 8 @ \$ 50.00                     | \$ 400.00          | 15 @ \$ 50.00      | \$ 750.00          | @ \$ 50.00 \$ -   |
| Test N Tune only           | @ \$ 10.00                       | \$ -               | @ \$ 10.00         | \$ -               | @ \$ 10.00 \$ -   |
| Late fees                  | 3 @ \$ 10.00                     | \$ 30.00           | 5 @ \$ 10.00       | \$ 50.00           | @ \$ 10.00 \$ -   |
| Temporary Memberships:     |                                  |                    |                    |                    |                   |
| At event                   | @ \$ 15.00                       | \$ -               | @ \$ 15.00         | \$ -               | @ \$ 15.00 \$ -   |
| Online                     | 8 @ \$ 15.00                     | \$ 120.00          | 15 @ \$ 15.00      | \$ 225.00          | @ \$ 15.00 \$ -   |
|                            |                                  |                    |                    |                    |                   |
|                            |                                  |                    |                    |                    |                   |
| <b>Total Income:</b>       |                                  | <b>\$ 2,500.00</b> |                    | <b>\$ 2,775.00</b> | <b>\$ -</b>       |
| <b>EXPENSES</b>            |                                  |                    |                    |                    |                   |
| Insurance:                 | 47 @ \$ 4.00                     | \$ 188.00          | 50 @ \$ 4.00       | \$ 200.00          | @ \$ 4.00 \$ -    |
| Sanction Fee:              | 47 @ \$ 5.00                     | \$ 235.00          | 50 @ \$ 6.50       | \$ 325.00          | @ \$ 6.50 \$ -    |
| Printing/Artwork:          |                                  | \$ -               |                    | \$ -               | \$ -              |
| Postage:                   |                                  | \$ -               |                    | \$ -               | \$ -              |
| Supplies:                  | Ice                              | \$ -               |                    | \$ 25.00           | \$ -              |
| Telephone:                 |                                  | \$ -               |                    | \$ -               | \$ -              |
| Trophies:                  |                                  | \$ -               |                    | \$ -               | \$ -              |
| Give-aways:                |                                  | \$ -               |                    | \$ -               | \$ -              |
| Rentals: Track             |                                  | \$ 800.00          |                    | \$ 800.00          | \$ -              |
| Port-a-potty               |                                  | \$ 85.00           |                    | \$ 85.00           | \$ -              |
| 4-wheeler rental           |                                  | \$ -               |                    | \$ -               | \$ -              |
| Fuel (region truck, etc.): |                                  | \$ -               |                    | \$ 110.00          | \$ -              |
| Worker Points              | 22 @ \$ 5.00                     | \$ 110.00          | 20 @ \$ 5.00       | \$ 100.00          | 15 @ \$ 5.00 \$ - |
| Weekend Member Fu          | 8 @ \$ 10.00                     | \$ 80.00           | 15 @ \$ 10.00      | \$ 150.00          | @ \$ 10.00 \$ -   |
| Miscellaneous:             |                                  | \$ -               |                    | \$ -               | \$ -              |
|                            |                                  |                    |                    |                    |                   |
|                            |                                  |                    |                    |                    |                   |
| <b>MSR fees</b>            |                                  | <b>\$ 104.43</b>   | 50 @ \$ 3.00       | <b>\$ 150.00</b>   | \$ -              |
|                            |                                  |                    |                    |                    |                   |
|                            |                                  |                    |                    |                    |                   |
| <b>Total Expense:</b>      |                                  | <b>\$ 1,602.43</b> |                    | <b>\$ 1,945.00</b> | <b>\$ -</b>       |
| <b>Surplus (Loss):</b>     |                                  | <b>\$ 897.57</b>   |                    | <b>\$ 830.00</b>   | <b>\$ -</b>       |

When grey shaded cell (entry fee) is filled in, balance of entry fees is automatically calculated. Insurance, sanction and new member fund (yellow shaded cells) are automatically calculated based on number of entries.

Reverse side of form to be used for additional explanations and comments as needed.

Budgeted statement must be submitted at least 60 days prior to event. For "Last Year Actual" figures, contact Treasurer and Registrar.

Final statement must be submitted to the Detroit Region Board of Directors within 30 days of event.

Expenses reimbursed **only** with receipts.

Signatures are required for both the budgeted and actual columns.

|   |                                     |                                     |  |
|---|-------------------------------------|-------------------------------------|--|
| <p><i>Jon Jareo</i></p> <p>Event Chairman</p> <p>7/29/2018</p> <p>Date Submitted</p> <p>/S/Jon Trudeau</p> <p>Director</p> <p>Date Approved by Board of Directors</p> | <p><i>Matt</i></p> <p><i>2d</i></p> | <p><i>BT</i></p> <p><i>Matt</i></p> | <p>Event Chairman</p> <p>Date Submitted</p> <p>Director</p> <p>Date Approved by Board of Directors</p> |
|---|-------------------------------------|-------------------------------------|--|

## Appendix 2 – Budget – Rallycross, I96 Speedway, October 6, 2018

### DETROIT REGION SCCA EVENT BUDGET - RALLYCROSS

APP 2

| Event:                        | Rallycross #10 @ I-96 Speedway |                         | Event Date(s): | October 6, 2018         |                         |
|-------------------------------|--------------------------------|-------------------------|----------------|-------------------------|-------------------------|
| Chairperson(s):               |                                |                         | Site:          | I-96 Speedway           |                         |
|                               | Oct 2017                       |                         | This Year      |                         | This Year               |
| INCOME                        | Actual (Crystal)               |                         | Budget (I-96)  |                         | Actual                  |
| <b>Entry fees:</b>            |                                |                         |                |                         |                         |
| Member                        | 15 @ \$ 50.00                  | \$ 750.00               | 35 @ \$ 50.00  | \$ 1,750.00             | @ \$ 50.00 \$ -         |
| Non-member                    | 12 @ \$ 50.00                  | \$ 600.00               | 15 @ \$ 50.00  | \$ 750.00               | @ \$ 50.00 \$ -         |
| Test N Tune only              | @ \$ 10.00                     | \$ -                    | @ \$ 10.00     | \$ -                    | @ \$ 10.00 \$ -         |
| Late fees                     | @ \$ 10.00                     | \$ -                    | 5 @ \$ 10.00   | \$ 50.00                | @ \$ 10.00 \$ -         |
| <b>Temporary Memberships:</b> |                                |                         |                |                         |                         |
| At event                      | @ \$ 15.00                     | \$ -                    | @ \$ 15.00     | \$ -                    | @ \$ 15.00 \$ -         |
| Online                        | 12 @ \$ 15.00                  | \$ 180.00               | 15 @ \$ 15.00  | \$ 225.00               | @ \$ 15.00 \$ -         |
| <b>Total Income:</b>          |                                | <b>\$ 1,530.00</b>      |                | <b>\$ 2,775.00</b>      | <b>\$ -</b>             |
| <b>EXPENSES</b>               |                                |                         |                |                         |                         |
|                               |                                | <b>This Year Actual</b> |                | <b>This Year Budget</b> | <b>This Year Actual</b> |
| Insurance:                    | 27 @ \$ 4.00                   | \$ 108.00               | 50 @ \$ 4.00   | \$ 200.00               | @ \$ 4.00 \$ -          |
| Sanction Fee:                 | 27 @ \$ 5.00                   | \$ 135.00               | 50 @ \$ 6.50   | \$ 325.00               | @ \$ 6.50 \$ -          |
| Printing/Artwork:             |                                | \$ -                    |                | \$ -                    | \$ -                    |
| Postage:                      |                                | \$ -                    |                | \$ -                    | \$ -                    |
| Supplies:                     | Ice                            | \$ 27.00                |                | \$ 25.00                | \$ -                    |
| Telephone:                    |                                | \$ -                    |                | \$ -                    | \$ -                    |
| Trophies:                     |                                | \$ -                    |                | \$ -                    | \$ -                    |
| Give-aways:                   |                                | \$ -                    |                | \$ -                    | \$ -                    |
| Rentals: Track                |                                | \$ 800.00               |                | \$ 1,000.00             | \$ -                    |
| Port-a-potty                  |                                | \$ 85.00                |                | \$ -                    | \$ -                    |
| 4-wheeler rental              |                                | \$ -                    |                | \$ -                    | \$ -                    |
| Fuel (region truck, etc.):    |                                | \$ 189.95               |                | \$ 110.00               | \$ -                    |
| Worker Points                 | 22 @ \$ 5.00                   | \$ 110.00               | 20 @ \$ 5.00   | \$ 100.00               | 15 @ \$ 5.00 \$ -       |
| Weekend Member Fl             | 12 @ \$ 10.00                  | \$ 120.00               | 15 @ \$ 10.00  | \$ 150.00               | @ \$ 10.00 \$ -         |
| Miscellaneous:                |                                | \$ -                    |                | \$ -                    | \$ -                    |
| MSR fees                      | 27 @ \$ 3.00                   | \$ 81.00                | 50 @ \$ 3.00   | \$ 150.00               | \$ -                    |
| <b>Total Expense:</b>         |                                | <b>\$ 1,655.95</b>      |                | <b>\$ 2,060.00</b>      | <b>\$ -</b>             |
| <b>Surplus (Loss):</b>        |                                | <b>\$ (125.95)</b>      |                | <b>\$ 715.00</b>        | <b>\$ -</b>             |

When grey shaded cell (entry fee) is filled in, balance of entry fees is automatically calculated. Insurance, sanction and new member fund (yellow shaded cells) are automatically calculated based on number of entries.

Reverse side of form to be used for additional explanations and comments as needed.

Budgeted statement must be submitted at least 60 days prior to event. For "Last Year Actual" figures, contact Treasurer and Registrar.

Final statement must be submitted to the Detroit Region Board of Directors within 30 days of event.

Expenses reimbursed **only** with receipts.

Signatures are required for both the budgeted and actual columns.

Mot JGR  
Zad SH  
✓

Event Chairman \_\_\_\_\_  
Date Submitted 7/11/2018  
Director /S/Jon Trudeau  
Date Approved by Board of Directors \_\_\_\_\_

Event Chairman \_\_\_\_\_  
Date Submitted \_\_\_\_\_  
Director \_\_\_\_\_  
Date Approved by Board of Directors \_\_\_\_\_

## Appendix 3 – Budget – Rallycross, Oakshade Raceway, November 3 & 4, 2018

### DETROIT REGION SCCA EVENT BUDGET - RALLYCROSS

App 3

| Event:                     | Rallycross #11&12 @ Oakshade Raceway |                           | Event Date(s):     | November 3&4, 2018 |                  |
|----------------------------|--------------------------------------|---------------------------|--------------------|--------------------|------------------|
| Chairperson(s):            |                                      |                           | Site:              | Oakshade Raceway   |                  |
|                            | Last Year                            |                           | This Year          |                    | This Year        |
|                            | Actual                               | COMBINED                  | Budget             | COMBINED           | Actual           |
| <b>INCOME</b>              |                                      |                           |                    |                    |                  |
| Entry fees:                |                                      |                           |                    |                    |                  |
| Both Days:                 |                                      |                           |                    |                    |                  |
| Member                     | 29 @ \$ 95.00 \$ 2,755.00            | 35 @ \$ 85.00 \$ 2,975.00 |                    | @ \$ 85.00 \$ -    |                  |
| Non-member                 | 11 @ \$ 95.00 \$ 1,045.00            | 15 @ \$ 85.00 \$ 1,275.00 |                    | @ \$ 85.00 \$ -    |                  |
| One Day:                   |                                      |                           |                    |                    |                  |
| Member                     | 8 \$ 50.00 400.00                    | 5 @ \$ 50.00 250.00       |                    | \$ 50.00 -         |                  |
| Non-member                 | 12 \$ 50.00 600.00                   | 5 @ \$ 50.00 250.00       |                    | \$ 50.00 -         |                  |
| Test N Tune only           | 1 @ \$ 10.00 \$ 10.00                | @ \$ 10.00 \$ -           |                    | @ \$ 10.00 \$ -    |                  |
| Late fees                  | 3 @ \$ 10.00 \$ 30.00                | @ \$ 10.00 \$ -           |                    | @ \$ 10.00 \$ -    |                  |
| Temporary Memberships:     |                                      |                           |                    |                    |                  |
| At event                   | @ \$ 15.00 \$ -                      | @ \$ 15.00 \$ -           |                    | @ \$ 15.00 \$ -    |                  |
| Online                     | 23 \$ 15.00 345.00                   | 20 \$ 15.00 300.00        |                    | \$ 15.00 -         |                  |
| Balaclava purchase         | \$ 6.00                              |                           |                    | \$ -               |                  |
| Test N Tune                | \$ 585.00                            |                           | \$ 500.00          | \$ -               |                  |
| <b>Total Income:</b>       | <b>\$ 5,776.00</b>                   |                           | <b>\$ 5,550.00</b> | <b>\$ -</b>        |                  |
| <b>EXPENSES</b>            |                                      |                           |                    |                    |                  |
|                            | <b>This Year</b>                     |                           | <b>This Year</b>   |                    | <b>This Year</b> |
|                            | <b>Actual</b>                        |                           | <b>Budget</b>      |                    | <b>Actual</b>    |
| Insurance:                 | 61 @ \$ 4.00 \$ 244.00               | 60 @ \$ 4.00 \$ 240.00    |                    | @ \$ 4.00 \$ -     |                  |
| Sanction Fee:              | 61 @ \$ 5.00 \$ 305.00               | 60 @ \$ 6.50 \$ 390.00    |                    | @ \$ 5.00 \$ -     |                  |
| Printing/Artwork:          | \$ -                                 | \$ -                      |                    | \$ -               |                  |
| Postage:                   | \$ -                                 | \$ -                      |                    | \$ -               |                  |
| Supplies:                  | \$ 110.97                            | \$ -                      |                    | \$ -               |                  |
| Telephone:                 | \$ -                                 | \$ -                      |                    | \$ -               |                  |
| Trophies:                  | \$ -                                 | \$ -                      |                    | \$ -               |                  |
| Give-aways:                | \$ -                                 | \$ -                      |                    | \$ -               |                  |
| Rentals: Track             | \$ 2,000.00                          | \$ 2,000.00               |                    | \$ -               |                  |
| Lights @ night             | \$ 300.00                            | \$ 300.00                 |                    | \$ -               |                  |
| 4-wheeler rental           | \$ -                                 | \$ -                      |                    | \$ -               |                  |
| Fuel (region truck, etc.): | \$ 242.45                            | \$ 225.00                 |                    | \$ -               |                  |
| Worker Points              | 40 @ \$ 5.00 \$ 200.00               | 40 @ \$ 5.00 \$ 200.00    |                    | @ \$ 5.00 \$ -     |                  |
| Weekend Member Fur         | 23 @ \$ 10.00 \$ 230.00              | 20 @ \$ 10.00 \$ 200.00   |                    | @ \$ 10.00 \$ -    |                  |
| Miscellaneous:             |                                      |                           |                    |                    |                  |
| Repairs                    | \$ -                                 | \$ -                      |                    | \$ -               |                  |
| Dinner                     | \$ -                                 | \$ 500.00                 |                    | \$ -               |                  |
| MSR fees                   | \$ 271.69                            | 60 @ \$ 3.00 \$ 180.00    |                    | \$ -               |                  |
|                            | \$ -                                 | \$ -                      |                    | \$ -               |                  |
|                            | \$ -                                 | \$ -                      |                    | \$ -               |                  |
|                            | \$ -                                 | \$ -                      |                    | \$ -               |                  |
|                            | \$ -                                 | \$ -                      |                    | \$ -               |                  |
|                            | \$ -                                 | \$ -                      |                    | \$ -               |                  |
| <b>Total Expense:</b>      | <b>\$ 3,904.11</b>                   |                           | <b>\$ 4,235.00</b> | <b>\$ -</b>        |                  |
| <b>Surplus (Loss):</b>     | <b>\$ 1,871.89</b>                   |                           | <b>\$ 1,315.00</b> | <b>\$ -</b>        |                  |

When grey shaded cell (entry fee) is filled in, balance of entry fees is automatically calculated. Insurance, sanction and new member fund (yellow shaded cells) are automatically calculated based on number of entries.

Reverse side of form to be used for additional explanations and comments as needed.

Budgeted statement must be submitted at least 60 days prior to event. For "Last Year Actual" figures, contact Treasurer and Registrar.

Final statement must be submitted to the Detroit Region Board of Directors within 30 days of event.

Expenses reimbursed **only** with receipts.

Signatures are required for both the budgeted and actual columns.

*Mike SH*  
*Red Circle*

*Matt Wilde*  
Event Chairman  
7/11/2017  
Date Submitted  
Jon Trudeau  
Director  
Date Approved by Board of Directors

Event Chairman  
Date Submitted  
Director  
Date Approved by Board of Directors

## Appendix 4 – Budget – Rallycross, Thistle Hill, December 1, 2018

APP 4

Event: Rallycross #13 at Thistle Hill Event Date(s): 1-Dec-18  
 Chairperson(s): \_\_\_\_\_ Event location: Thistle Hill

|                        | <u>Dec 2017</u> |                    | <u>This Year</u> |                    | <u>This Year</u> |             |
|------------------------|-----------------|--------------------|------------------|--------------------|------------------|-------------|
|                        | <u>Actual</u>   |                    | <u>Budget</u>    |                    | <u>Actual</u>    |             |
| <b>INCOME</b>          |                 |                    |                  |                    |                  |             |
| Entry fees:            |                 |                    |                  |                    |                  |             |
| Member                 | 50 @ \$ 50.00   | \$ 2,500.00        | 45 @ \$ 50.00    | \$ 2,250.00        | @ \$ 50.00       | \$ -        |
| Non-member             | @ \$ 50.00      | \$ -               | 5 @ \$ 50.00     | \$ 250.00          | @ \$ 50.00       | \$ -        |
| Late fees              | @ \$ 10.00      | \$ -               | 5 @ \$ 10.00     | \$ 50.00           | @ \$ 10.00       | \$ -        |
| Temporary Memberships: |                 |                    |                  |                    |                  |             |
| At event               | @ \$ 15.00      | \$ -               | @ \$ 15.00       | \$ -               | @ \$ 15.00       | \$ -        |
| Online                 | 7 @ \$ 15.00    | \$ 105.00          | 5 @ \$ 15.00     | \$ 75.00           | @ \$ 15.00       | \$ -        |
| <b>Total Income:</b>   |                 | <b>\$ 2,605.00</b> |                  | <b>\$ 2,625.00</b> |                  | <b>\$ -</b> |

|                              | <u>Last Year</u> |                    | <u>This Year</u>        |                    | <u>This Year</u>        |             |
|------------------------------|------------------|--------------------|-------------------------|--------------------|-------------------------|-------------|
|                              | <u>Actual</u>    |                    | <u>Budget</u>           |                    | <u>Actual</u>           |             |
| <b>EXPENSES</b>              |                  |                    |                         |                    |                         |             |
| Insurance:                   | 50 @ \$ 4.00     | \$ 200.00          | 50 @ \$ 4.00            | \$ 200.00          | @ \$ 4.00               | \$ -        |
| Sanction Fee:                | 50 @ \$ 5.00     | \$ 250.00          | 50 @ \$ 6.50            | \$ 325.00          | @ \$ 6.50               | \$ -        |
| MSR Fee:                     | @                | \$ 139.57          | 50 @ \$ 3.00            | \$ 150.00          | @ \$ 3.00               | \$ -        |
| Application fee:             |                  | \$ -               |                         | \$ -               |                         | \$ -        |
| Printing/Artwork:            |                  | \$ -               |                         | \$ -               |                         | \$ -        |
| Postage:                     |                  | \$ -               |                         | \$ -               |                         | \$ -        |
| Supplies:                    |                  | \$ -               |                         | \$ -               |                         | \$ -        |
| Telephone:                   |                  | \$ -               |                         | \$ -               |                         | \$ -        |
| Trophies:                    |                  | \$ -               |                         | \$ -               |                         | \$ -        |
| Give-aways:                  |                  | \$ -               |                         | \$ -               |                         | \$ -        |
| Rentals: Track:              |                  | \$ 800.00          | Thistle Hill (J. Glass) | \$ 800.00          | Thistle Hill (J. Glass) | \$ -        |
| Other (porta-potties, etc.): |                  | \$ 105.00          |                         | \$ 105.00          |                         | \$ -        |
| Fuel (region truck, etc.):   |                  | \$ 35.73           |                         | \$ 15.00           |                         | \$ -        |
| Worker Points                | 21 @ \$ 5.00     | \$ 105.00          | 25 @ \$ 5.00            | \$ 125.00          | @ \$ 5.00               | \$ -        |
| Weekend Membership           | 7 @ \$ 10.00     | \$ 70.00           | 5 @ \$ 10.00            | \$ 50.00           | @ \$ 10.00              | \$ -        |
| Miscellaneous:               |                  | \$ -               |                         | \$ -               |                         | \$ -        |
| ATV Rental                   |                  | \$ -               |                         | \$ -               |                         | \$ -        |
| Repairs                      |                  | \$ -               |                         | \$ -               |                         | \$ -        |
| hand warmers                 |                  | \$ -               |                         | \$ -               |                         | \$ -        |
| New Member Fund              |                  | \$ -               |                         | \$ -               |                         | \$ -        |
|                              | 7 @ \$ 5.00      | \$ 35.00           |                         | \$ -               |                         | \$ -        |
| <b>Total Expense:</b>        |                  | <b>\$ 1,740.30</b> |                         | <b>\$ 1,770.00</b> |                         | <b>\$ -</b> |
| <b>Surplus (Loss):</b>       |                  | <b>\$ 864.70</b>   |                         | <b>\$ 855.00</b>   |                         | <b>\$ -</b> |

When grey shaded cell (entry fee) is filled in, balance of entry fees is automatically calculated. Insurance, sanction and new member fund (yellow shaded cells) are automatically calculated based on number of entries.  
 Reverse side of form to be used for additional explanations and comments as needed.  
 Budgeted statement must be submitted at least 60 days prior to event. For "Last Year Actual" figures, contact Treasurer and Registrar.  
 Final statement must be submitted to the Detroit Region Board of Directors within 30 days of event.  
 Expenses reimbursed **only** with receipts.

Signatures are required for both the budgeted and actual columns.

JK  
2nd Matt W.

Jon Glass  
 Event Chairman  
7/11/2018  
 Date Submitted  
Jon Trudeau  
 Director  
 \_\_\_\_\_  
 Date Approved by Board of Directors

\_\_\_\_\_  
 Event Chairman  
 \_\_\_\_\_  
 Date Submitted  
 \_\_\_\_\_  
 Director  
 \_\_\_\_\_  
 Date Approved by Board of Directors

## Appendix 5 – Budget – Autocross, Fall into Autumn, Schoolcraft, September 30, 2018

APP 5

### DETROIT REGION SCCA EVENT BUDGET - SOLO

| Event:                     | Fall Into Autumn |                    | Event Date(s):   |                        | 9/30/2018        |                |
|----------------------------|------------------|--------------------|------------------|------------------------|------------------|----------------|
| Chairperson(s):            | Ray Jason        |                    | Site Location:   |                        | Schoolcraft PSTC |                |
|                            | Last Year Actual |                    | This Year Budget |                        | This Year Actual |                |
| <b>INCOME</b>              |                  |                    |                  |                        |                  |                |
| Entry fees:                |                  |                    |                  |                        |                  |                |
| Member                     | 93 @ \$35 00     | \$ 3,255 00        | 93 @ \$35 00     | \$ 3,255 00            | 0 @ \$35 00      | \$ 0 00        |
| Council                    | 4 @ \$40 00      | \$ 160 00          | 4 @ \$40 00      | \$ 160 00              | 0 @ \$40 00      | \$ 0 00        |
| No Affiliation             | 36 @ \$50 00     | \$ 1,800 00        | 36 @ \$50 00     | \$ 1,800 00            | 0 @ \$50 00      | \$ 0 00        |
| Jr Kart                    | 7 @ \$20 00      | \$ 140 00          | 7 @ \$20 00      | \$ 140 00              | 0 @ \$20 00      | \$ 0 00        |
|                            | 0 @ \$0 00       | \$ 0 00            | 0 @ \$0 00       | \$ 0 00                | 0 @ \$0 00       | \$ 0 00        |
|                            | 0 @ \$0 00       | \$ 0 00            | 0 @ \$0 00       | \$ 0 00                | 0 @ \$0 00       | \$ 0 00        |
| Other Income               | @                | \$                 | @                | \$                     | @                | \$             |
| Other Income               | @                | \$                 | @                | \$                     | @                | \$             |
| <b>Total Income:</b>       |                  | <b>\$ 5,355 00</b> |                  | <b>\$ 5,355 00</b>     |                  | <b>\$ 0 00</b> |
| <b>EXPENSES</b>            |                  |                    |                  |                        |                  |                |
| Insurance                  | \$6 50 @ 140     | \$ 910 00          | @ 140            | \$ 40 00               | @ 0              | \$ 40 00       |
| Sanction Fee:              | \$6 50 @ 140     | \$ 910 00          | @ 140            | \$ 40 00               | @ 0              | \$ 40 00       |
| Printing/Artwork:          |                  | \$ 0 00            |                  | \$ 0 00                |                  | \$ 0 00        |
| Postage:                   |                  | \$ 0 00            |                  | \$ 0 00                |                  | \$ 0 00        |
| Supplies:                  |                  | \$ 31 69           |                  | \$ 0 00                |                  | \$ 0 00        |
| Telephone:                 |                  | \$ 0 00            |                  | \$ 0 00                |                  | \$ 0 00        |
| Trophies:                  |                  | \$ 126 00          |                  | \$ 100 00              |                  | \$ 0 00        |
| Give-aways:                |                  | \$ 0 00            |                  | \$ 0 00                |                  | \$ 0 00        |
| Rentals: Track:            |                  | \$ 1200 00         |                  | \$ 1200 00             |                  | \$ 0 00        |
| Porta-Poties:              |                  | \$ 0 00            |                  | \$ 0 00                |                  | \$ 0 00        |
| Security                   |                  | \$ 0 00            |                  | \$ 0 00                |                  | \$ 0 00        |
|                            |                  | \$ 0 00            |                  | \$ 0 00                |                  | \$ 0 00        |
| Registration Fees:         |                  | \$ 224 82          |                  | \$ 250 00              |                  | \$ 0 00        |
| Fuel:                      |                  | \$ 50 00           |                  | \$ 50 00               |                  | \$ 0 00        |
| Worker Points: 30 @ \$5 00 |                  | \$ 150 00          | 30 @ \$5 00      | \$ 150 00              | 0 @ \$5 00       | \$ 0 00        |
| New Member Fund:           |                  | \$ 360 00          | 36 @ \$10 00     | \$ 360 00              | 0 @ \$10 00      | \$ 0 00        |
| Miscellaneous:             |                  | \$ 0 00            |                  | \$ 0 00                |                  | \$ 0 00        |
| Water & Ice                |                  | \$ 15 51           |                  | \$ 20 00               |                  | \$ 0 00        |
| American Cancer Society    |                  | \$ 0 00            |                  | \$ 980.00 1820         |                  | \$ 0 00        |
|                            |                  | \$ 0 00            |                  | \$ 0 00                |                  | \$ 0 00        |
|                            |                  | \$ 0 00            |                  | \$ 0 00                |                  | \$ 0 00        |
| <b>Total Expense:</b>      |                  | <b>\$ 3978 02</b>  |                  | <b>\$ 3170.00 4010</b> |                  | <b>\$ 0 00</b> |
| <b>Surplus (Loss):</b>     |                  | <b>\$ 1376 98</b>  |                  | <b>\$ 2185.00 1345</b> |                  | <b>\$ 0 00</b> |

When grey shaded cell (entry fee) is filled in, balance of entry fees is automatically calculated. Insurance, sanction and new member fund (yellow shaded cells) are automatically calculated based on number of entries.

Reverse side of form to be used for additional explanations and comments as needed.

Final statement must be submitted to the Detroit Region Board of Directors within 30 days of event.

Expenses reimbursed **only with receipts**.

Signatures are required for both the budgeted and actual columns.

*[Signature]*  
Event Chairman

*Motter*  
*2nd JG*

Event Chairman  
Copy of Event Budget Form - Solo

Rev /6/2018

*Motter to change donation to \$13/car*  
*Motter as agreed. JK, 2nd JG.*



## Appendix 6 – Budget - Autocross, Season Ender, MIS, October 13, 2018

APP 6

### DETROIT REGION SCCA EVENT BUDGET - SOLO

| Event:                 |              | Season Ender       |               | Event Date(s):     |             | 10/13/2018     |  |
|------------------------|--------------|--------------------|---------------|--------------------|-------------|----------------|--|
| Chairperson(s):        |              | Frank Putman       |               | Site Location:     |             | MIS            |  |
|                        |              | Last Year          |               | This Year          |             | This Year      |  |
|                        |              | Actual             |               | Budget             |             | Actual         |  |
| <b>INCOME</b>          |              |                    |               |                    |             |                |  |
| Entry fees:            |              |                    |               |                    |             |                |  |
| Member                 | 99 @ \$35.00 | \$ 3,465.00        | 105 @ \$40.00 | \$ 4,200.00        | 0 @ \$40.00 | \$ 0.00        |  |
| Council                | 6 @ \$40.00  | \$ 240.00          | 6 @ \$45.00   | \$ 270.00          | 0 @ \$45.00 | \$ 0.00        |  |
| No Affiliation         | 29 @ \$50.00 | \$ 1,450.00        | 34 @ \$55.00  | \$ 1,870.00        | 0 @ \$55.00 | \$ 0.00        |  |
| Jr Kart                | 5 @ \$20.00  | \$ 100.00          | 5 @ \$25.00   | \$ 125.00          | 0 @ \$20.00 | \$ 0.00        |  |
|                        | 0 @ \$0.00   | \$ 0.00            | 0 @ \$0.00    | \$ 0.00            | 0 @ \$0.00  | \$ 0.00        |  |
|                        | 0 @ \$0.00   | \$ 0.00            | 0 @ \$0.00    | \$ 0.00            | 0 @ \$0.00  | \$ 0.00        |  |
| Other Income           | @            | \$                 | @             | \$                 | @           | \$             |  |
| Other Income           | @            | \$                 | @             | \$                 | @           | \$             |  |
| <b>Total Income:</b>   |              | <b>\$ 5,255.00</b> |               | <b>\$ 6,465.00</b> |             | <b>\$ 0.00</b> |  |
| <b>EXPENSES</b>        |              |                    |               |                    |             |                |  |
| Insurance              | \$6.50 @ 139 | \$ 903.50          | \$ 6.50 @ 150 | \$ 975.00          | \$ 6.50 @ 0 | \$ 0.00        |  |
| Sanction Fee:          | \$6.50 @ 139 | \$ 80.00           | \$ 6.50 @ 150 | \$ 975.00          | \$ 6.50 @ 0 | \$ 0.00        |  |
| Printing/Artwork:      |              | \$ 0.00            |               | \$ 0.00            |             | \$ 0.00        |  |
| Postage:               |              | \$ 0.00            |               | \$ 0.00            |             | \$ 0.00        |  |
| Supplies:              |              | \$ 37.95           |               | \$ 40.00           |             | \$ 0.00        |  |
| Telephone:             |              | \$ 0.00            |               | \$ 0.00            |             | \$ 0.00        |  |
| Trophies:              |              | \$ 126.00          |               | \$ 100.00          |             | \$ 0.00        |  |
| Give-aways:            |              | \$ 0.00            |               | \$ 0.00            |             | \$ 0.00        |  |
| Rentals: Track:        |              | \$ 2000.00         |               | \$ 2500.00         |             | \$ 0.00        |  |
| Porta-Poties:          |              | \$ 160.00          |               | \$ 0.00            |             | \$ 0.00        |  |
| Security               |              | \$ 600.00          |               | \$ 0.00            |             | \$ 0.00        |  |
|                        |              | \$ 0.00            |               | \$ 0.00            |             | \$ 0.00        |  |
| Registration Fees:     |              | \$ 222.69          |               | \$ 225.00          |             | \$ 0.00        |  |
| Fuel:                  |              | \$ 50.00           |               | \$ 50.00           |             | \$ 0.00        |  |
| Worker Points:         | 28 @ \$5.00  | \$ 140.00          | 28 @ \$5.00   | \$ 140.00          | 0 @ \$5.00  | \$ 0.00        |  |
| New Member Fund:       |              | \$ 350.00          | 40 @ \$10.00  | \$ 400.00          | 0 @ \$10.00 | \$ 0.00        |  |
| Miscellaneous:         |              | \$ 0.00            |               | \$ 0.00            |             | \$ 0.00        |  |
| Water & Ice            |              | \$ 0.00            |               | \$ 20.00           |             | \$ 0.00        |  |
| Donuts                 |              | \$ 0.00            |               | \$ 20.00           |             | \$ 0.00        |  |
|                        |              | \$ 0.00            |               | \$ 0.00            |             | \$ 0.00        |  |
|                        |              | \$ 0.00            |               | \$ 0.00            |             | \$ 0.00        |  |
| <b>Total Expense:</b>  |              | <b>\$ 4670.14</b>  |               | <b>\$ 5445.00</b>  |             | <b>\$ 0.00</b> |  |
| <b>Surplus (Loss):</b> |              | <b>\$ 584.86</b>   |               | <b>\$ 1020.00</b>  |             | <b>\$ 0.00</b> |  |

When grey shaded cell (entry fee) is filled in, balance of entry fees is automatically calculated. Insurance, sanction and new member fund (yellow shaded cells) are automatically calculated based on number of entries.

Reverse side of form to be used for additional explanations and comments as needed.

Final statement must be submitted to the Detroit Region Board of Directors within 30 days of event.

Expenses reimbursed only with receipts.

Signatures are required for both the budgeted and actual columns.

*Frank Putman*  
 \_\_\_\_\_  
 Event Chairman  
 8/8/2018  
 \_\_\_\_\_  
 Date

*Moto Cindy Matt*  
*2dc*  
*Uran*  
 \_\_\_\_\_  
 Event Chairman  
 \_\_\_\_\_  
 Date

\_\_\_\_\_  
 Autocross Director

\_\_\_\_\_  
 Autocross Director

## Appendix 7 – Budget - TSD Rally, Pavement Ends, November 10, 2018

APP 7

Event: Pavement Ends 2018 Event Date(s): November 10, 2018  
 Chairperson(s): John Kytasty/Adam Spieszny/Piotr Roszczenko

|                                  | <u>Last Year</u> |                  | <u>This Year</u> |                  | <u>This Year</u> |             |
|----------------------------------|------------------|------------------|------------------|------------------|------------------|-------------|
|                                  | <u>Actual</u>    |                  | <u>Budget</u>    |                  | <u>Actual</u>    |             |
| <b>INCOME</b>                    |                  |                  |                  |                  |                  |             |
| Entry fees:                      |                  |                  |                  |                  |                  |             |
| Member                           | 17 @             | \$ 40.00         | \$ 680.00        | 15 @             | \$ 40.00         | \$ 600.00   |
| Non-member                       | @                | \$ 45.00         | \$ -             | @                | \$ 45.00         | \$ -        |
| Late fees                        | 2 @              | \$ 10.00         | \$ 20.00         | @                | \$ 5.00          | \$ -        |
| R SCH Disc                       |                  | \$ 20.00         |                  | @                | \$ 20.00         | \$ -        |
| Temporary Memberships:           |                  |                  |                  |                  |                  |             |
| 1 Non-member                     | @                | \$ -             | \$ -             | @                | \$ -             | \$ -        |
| 2 Non-members                    | 2 @              | \$ 5.00          | \$ 10.00         | 2 @              | \$ 5.00          | \$ 10.00    |
| Other Income                     |                  | \$ -             | \$ -             |                  | \$ -             | \$ -        |
|                                  |                  | \$ -             | \$ -             |                  | \$ -             | \$ -        |
| <b>Total Income:</b>             |                  | <b>\$ 710.00</b> |                  | <b>\$ 610.00</b> |                  | <b>\$ -</b> |
| <b>EXPENSES</b>                  |                  |                  |                  |                  |                  |             |
| Insurance:                       | 17 @             | \$ 4.00          | \$ 68.00         | 15 @             | \$ 4.00          | \$ 60.00    |
| Sanction Fee:                    | 17 @             | \$ 4.00          | \$ 68.00         | 15 @             | \$ 4.00          | \$ 60.00    |
| Sanction Application Fee:        |                  | \$ -             | \$ -             |                  | \$ -             | \$ -        |
| GLDiv trophy:                    | 17 @             | \$ 3.00          | \$ 51.00         | 15 @             | \$ 3.00          | \$ 45.00    |
| Printing/Artwork:                |                  | \$ 101.79        | \$ 101.79        |                  | \$ 50.00         | \$ 50.00    |
| Postage:                         |                  | \$ -             | \$ -             |                  | \$ -             | \$ -        |
| Supplies:                        |                  | \$ 38.66         | \$ 38.66         |                  | \$ 25.00         | \$ 25.00    |
| Telephone:                       |                  | \$ -             | \$ -             |                  | \$ -             | \$ -        |
| Trophies:                        | 10 @             | \$ 3.00          | \$ 31.98         | 10 @             | \$ 3.00          | \$ 30.00    |
| Give-aways:                      |                  | \$ 39.24         | \$ 39.24         |                  | \$ -             | \$ -        |
| Rentals:                         |                  | \$ -             | \$ -             |                  | \$ -             | \$ -        |
| Fuel (course layout, etc.):      |                  | \$ 94.38         | \$ 94.38         |                  | \$ 200.00        | \$ 200.00   |
| Worker Points                    | 19 @             | \$ 5.00          | \$ 95.00         | 20 @             | \$ 5.00          | \$ 100.00   |
| Weekend Memberships              | @                | \$ -             | \$ -             | @                | \$ 5.00          | \$ -        |
| Miscellaneous:                   |                  | \$ -             | \$ -             |                  | \$ -             | \$ -        |
| Hospitality                      |                  | \$ -             | \$ -             |                  | \$ -             | \$ -        |
| Room Rental (event start/finish) |                  | \$ -             | \$ -             |                  | \$ -             | \$ -        |
|                                  |                  | \$ -             | \$ -             |                  | \$ -             | \$ -        |
| MSR FEES                         |                  | \$ 34.20         | \$ 34.20         |                  | \$ 30.00         | \$ 30.00    |
|                                  |                  | \$ -             | \$ -             |                  | \$ -             | \$ -        |
| <b>Total Expense:</b>            |                  | <b>\$ 622.25</b> |                  | <b>\$ 600.00</b> |                  | <b>\$ -</b> |
| <b>Surplus (Loss):</b>           |                  | <b>\$ 87.75</b>  |                  | <b>\$ 10.00</b>  |                  | <b>\$ -</b> |

When grey shaded cell (entry fee) is filled in, balance of entry fees is automatically calculated. Insurance, sanction and new member fund (yellow shaded cells) are automatically calculated based on number of entries.

Reverse side of form to be used for additional explanations and comments as needed.

Budgeted statement must be submitted at least 60 days prior to event. For "Last Year Actual" figures, contact Treasurer and Registrar.

Final statement must be submitted to the Detroit Region Board of Directors within 30 days of event.

Expenses reimbursed **only** with receipts.

Signatures are required for both the budgeted and actual columns.

John Kytasty/Adam Spieszny/Piotr Roszczenko  
Event Chairman

8/8/2018  
Date Submitted

John Fishbeck  
Director

\_\_\_\_\_  
Date Approved by Board of Directors

\_\_\_\_\_  
Event Chairman

\_\_\_\_\_  
Date Submitted

\_\_\_\_\_  
Director

\_\_\_\_\_  
Date Approved by Board of Directors

*Uran*

## Appendix 8 – Narcan Nasal Spray

# \* NARCAN<sup>®</sup> (naloxone HCl) NASAL SPRAY

APP 8

## QUICK START GUIDE

### Opioid Overdose Response Instructions

Use NARCAN Nasal Spray (naloxone hydrochloride) for known or suspected opioid overdose in adults and children.

**Important: For use in the nose only.**

**Do not remove or test the NARCAN Nasal Spray until ready to use.**

### 1 Identify Opioid Overdose and Check for Response

- Ask** person if he or she is okay and shout name.
  - Shake** shoulders and firmly rub the middle of their chest.
  - Check for signs of opioid overdose:**
    - Will not wake up or respond to your voice or touch
    - Breathing is very slow, irregular, or has stopped
    - Center part of their eye is very small, sometimes called “pinpoint pupils”
- Lay the person on their back to receive a dose of NARCAN Nasal Spray.



### 2 Give NARCAN Nasal Spray

- Remove** NARCAN Nasal Spray from the box.
- Peel back the tab with the circle to open the NARCAN Nasal Spray.

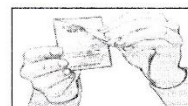

- Hold** the NARCAN nasal spray with your thumb on the bottom of the plunger and your first and middle fingers on either side of the nozzle.



- Gently insert the tip of the nozzle into either nostril.**

- Tilt the person’s head back and provide support under the neck with your hand. Gently insert the tip of the nozzle into **one nostril**, until your fingers on either side of the nozzle are against the bottom of the person’s nose.



- Press the plunger firmly** to give the dose of NARCAN Nasal Spray.

- Remove the NARCAN Nasal Spray from the nostril after giving the dose.

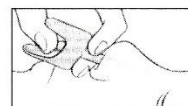

### 3 Call for emergency medical help, Evaluate, and Support

- Get emergency medical help right away.**

- Move the person on their side (recovery position)** after giving NARCAN Nasal Spray.

- Watch the person closely.**

- If the person does not respond** by waking up, to voice or touch, or breathing normally another dose may be given. NARCAN Nasal Spray may be dosed every 2 to 3 minutes, if available.

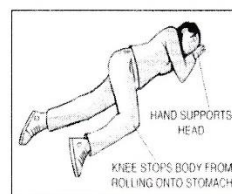

- Repeat Step 2 using a new NARCAN Nasal Spray to give another dose in the other nostril.** If additional NARCAN Nasal Sprays are available, repeat step 2 every 2 to 3 minutes until the person responds or emergency medical help is received.

For more information about NARCAN Nasal Spray, go to [www.narcannasalspray.com](http://www.narcannasalspray.com), or call 1-844-4NARCAN (1-844-462-7226).



©2015 ADAPT Pharma, Inc. NARCAN<sup>®</sup> is a registered trademark licensed to ADAPT Pharma Operations Limited. A1009.01

## Appendix 9 – RE Letter to MI DNR re continuation of the Detroit Grand Prix (Page 1)

Detroit Region SCCA



Michigan Department of Natural Resources  
Belle Isle Park Advisory Committee  
Belle Isle Nature Center  
176 Lakeside Drive  
Detroit, MI 48207

Aug 02, 2018

Subject: DNR Grand Prix Proposal

Dear Committee Member:

By way of introduction, I represent and lead the Detroit Region of the Sports Car Club of America, a 501(c) (4) non-profit organization. Our Region covers most of southeast Michigan from Detroit to Ann Arbor and Monroe to Oscoda. We are the fifth largest region with 1400 members and a charter member region of the national Sports Car Club of America (SCCA), with a total membership of 67,000 members, motorsports enthusiasts, competitors, corner workers, race officials, safety, fire and crash/rescue personnel. The SCCA annually sanctions over 2000 professional and amateur motorsports events throughout the nation. Locally, the Detroit Region provides 150 volunteer personnel to directly support all aspects of the Detroit Grand Prix race weekend from planning to race administration, race conduct, flagging and communications, scoring, fire/rescue, track support, and race related equipment and supplies. Additionally, the SCCA is the sanctioning body for one of the weekends two support races, the Trans Am Series. The Trans Am showcases the Chevrolet Camaro, Ford Mustang, and Dodge Challenger racing for our local automobile company's bragging rights!

So that is who we are, and what we do. I would like to present to the committee, my personal and professional views of the impact that the Detroit Grand Prix at Belle Isle has locally, nationally, and internationally. I will leave it to others more qualified than I to present the direct economic impact, the growth of good will, and the positive portrait of Detroit's vibrant comeback. Instead, I would like to focus my comments on the positive ecological impact that the Detroit Grand Prix plays in the broader global picture of the ecological improvements and advances that we have experienced and enjoyed over the past 50 years. It is important to review and recognize past achievements and current improvements with linkage to the causes and developments that lead to these improvements and achievements. Entire books have been written regarding this subject, however, I will attempt to do this justice in just a few sentences. In order to accomplish this, one must look at the Detroit Grand Prix as a link in a chain. The chain is the global automotive/transportation industry of which motorsports is a part. It consists of the car companies, their suppliers, the research activities, including private companies, colleges and universities, government departments, the energy industry, and the natural resource providers. This is just a short list of the links large and small that make up this chain and is not at all inclusive.

Many on this committee and in this audience may remember the state of water and air quality in the 1970's and 1980's. Rivers feeding Lake Erie routinely caught on fire. Great lakes fish were prohibited from consumption. Industrial runoff from waterways adjacent to factories polluted rivers, lakes, and drinking water supplies. Air quality in

## Appendix 9 – RE Letter to MI DNR re continuation of the Detroit Grand Prix (Page 2)

*Detroit Region SCCA*



most cities was poor at best. Los Angeles smog covered southern California with a yellow-green haze that jeopardized health and safety. Acid rain fell from the skies caused mainly by the discharge of industrial gases into the atmosphere.

As a young cadet at West Point in 1970, I experienced and participated in the first Earth Day. My interest in the environmental movement began much earlier as son of a rancher and farmer in Northern California. My grandfather and father expressed the importance and practice of stewarding the land and protecting our water resources. One of my college projects included cataloging the environmental state of the Hudson River Valley from New York City to West Point, 50 miles to the north. Industry pollution, waste water runoff, and two nuclear power plants contributed to the existing conditions. This project culminated in the creation of a multi-media presentation that was used for a time by the Department of Earth, Space, and Graphic Sciences at West Point. Over the course of my careers, including my recent retirement as a Global Forward Model Powertrain Engineer at Ford Motor Company, I have witnessed many of the problems and solutions to these environmental issues.

Fast forward 50 years to today. While we recognize that environmental issues and problems still exist, the improvements over this period of time are extraordinary. The Detroit River and adjacent watersheds and the Hudson River watershed have been improved to the point where for the most part, water quality is acceptable and fish are safe to eat. Air quality is immensely improved. Smog is a minor issue in the Los Angeles basin and in many other cities throughout the nation. Almost no one today refers to acid rain as an immense problem or issue. And improvements to current conditions continue to be researched and implemented.

It is this research and implementation of environmental and quality of life solutions that bring us back to the chain that includes the Detroit Grand Prix. The global automotive industry and the related energy and natural resource providers have for the most part funded, researched, and implemented the solutions that we now and in the future will enjoy as environmental conditions continue to improve. Harmful vehicle emissions are greatly reduced. Improved fuel economy, refinement and improvements in supply have resulted. Improvements in manufacturing, recycling, water treatment, and materials research have contributed to these efforts. Powertrain options including electric vehicles, hybrids, and fuel cell vehicles continue to be researched and implemented. Much of the testing, research, and development for these improvements are conducted in the motorsports environment. Racing has led to many significant safety improvements, engine management systems to improve fuel economy and emissions reduction, tire research, and much more. Hybrid and all electric racing vehicles are now competing on a limited basis globally as the technology advances.

For the automotive/transportation industry chain to be strong and profitable to fund research and growth, the many links must remain strong and profitable as well. The Detroit Grand Prix is a major global motorsports event, one of a number of events that

## Appendix 9 – RE Letter to MI DNR re continuation of the Detroit Grand Prix (Page 3)

*Detroit Region SCCA*



make up the Indy Car, IMSA, and Trans AM schedules. When combined with the FIA Formula 1 global schedule and others, this combined link is a strong and contributing component of the chain. As stated, the chain provides research, testing, and development, it promotes the communities and venues they visit, it creates economic activity and wealth, it provides an advertising and marketing platform for our hometown car companies, and is a source of excitement, enthusiasm, and pride for our residents and visitors alike.

But what if the Detroit Grand Prix at Belle Isle ceases to exist? A chain is only as strong as its weakest link. The loss of an event, actually two events, of this size and magnitude may not break the chain, but it will greatly weaken it. And who knows, drop an event here or there and the resulting loss of profit may cause a racing organization to fail. It has happened before. And if the chain is weakened, can the investment in research, testing, and development continue to provide the quality of life improvements that we want and desire.

I speak for myself and the 1400 members of the Detroit Region SCCA in support to keeping the Detroit Grand Prix at Belle Isle. Thank you for your consideration.

With Warmest Regards,

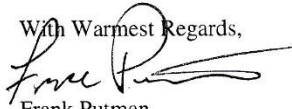

Frank Putman  
Detroit Region Executive  
Sports Car Club of America  
517.438.2589

## Appendix 10 – Agenda, August 8 BOD Meeting

### Detroit Region SCCA



August 8, 2018  
Board of Directors Meeting  
On the Border  
21091 Haggerty Rd  
Novi, MI

Board Meeting 7:00 pm  
Agenda:

1. Current Business and Online Business
  - a. July BOD Meeting Minutes not approved online.
  - b. Updated BOD Policies for travel reimbursement are in progress.
  - c. Update search for Web Master.
  - d. Update Budget Submission Review and Capital Spending Forecast sub-committee.
  - e. Thayer Automotive Sponsorship follow up, \$1200 for RallyX.
2. Reports (including new/updated 2018 Event Budgets and follow up)
  - a. Race
    - 2019/2020 Majors date changes
    - Time Trials
  - b. Rallycross
    - #7 & #8\_ July 28/29\_GLD Challenge\_ I96 Raceway
    - #9\_Crystal Speedway\_25 August 2018
    - Event Budgets
  - c. Solo
    - After the Fireworks \_July 13-14\_ Oscoda (Tate/DET)
    - Oscoda Pro Solo \_Aug 3- 5\_ Oscoda (M. Merideth)
    - Before Nationals\_ Aug 17-19\_ Oscoda (Tate/SVR)
    - Event Budgets\_ Fall into Autumn, Season Ender
  - d. Rally
    - Moonlight Monte \_July 21\_ South Lyon
    - Press on Regardless
    - Event Budgets
  - e. Asst. RE
    - 2018 Awards Banquet Update
  - f. RE
    - 2019 Convention Membership presentation/round table.
  - g. Treasurer
  - h. Membership report
  - i. Equipment
    - Conquistidor new tires update
    - Fire Extinguishers\_ Status: tag vs gauge
  - j. Open Exhaust
  - k. Street Survival® \_ Fowlerville\_ Sep 22 (Penn)
  - l. Website/Social media
  - m. Special Events
    - FSAE\_ Final Budget
    - DGP\_ Follow up contract renewal/ meetings
    - Empire Hill Climb\_ Update
  - n. Social events
    - 70<sup>th</sup> Anniversary Event (John Li, Keith Armitage, John Kytasty )
  - o. Calendar Review
3. New Business
  - a. New Business/walk-ins/comments
    - Congratulations Matt & Andie
4. Sept 12, 2018 Meeting Date and Location
  - a. Meeting Location\_ On-the-Border\_7:00 pm
5. Adjourn

## Appendix 11 – Thayer Automotive Sponsorship

### Notes by Jon Trudeau:

Hi Frank - Per our short call, I was finally able to reach Adam Thayer. He does not want to increase the sponsorship from the current \$1200 level (I asked if he wanted to do \$1400 even, but he was not interested). He also did not see the value to Thayer Auto to sponsor the POR rally as it is well outside of his business selling region. So he requested to send him an invoice for \$1200 for just the rallycross sponsorship.

Frank/Jen - Please generate an invoice for \$1200 and email him [adam.thayer@thayerauto.com](mailto:adam.thayer@thayerauto.com). In the invoice and/or email we must include what his sponsorship dollars are doing for him. Webpage(s) and social media exposure, headline on all MSReg entrants, Open Exhaust letter, signage at the events, recognition on all Rx monthly & year end trophies, stickers on Rx cars, etc. The Thayer name is plastered on about anything and everything, we need him to understand this and feel his sponsorship is a good investment.

Matt - When Frank and I met with Adam in June, he suggested placing our marketing/social media person (i.e. you) in touch with Thayer's (Kim Gusway 734-838-1823) for alignment and cross exposure. There is definitely more potential rallycross program exposure if we can link our media with Thayer's. So please contact her.

One potential program that could be fun and bring in more rallycross participants is to offer buyers of Thayer automobiles one free entry for a rallycross event. Frank pitched this a bit in our face to face meeting with Adam. Likely only for used cars from the VW & Mazda dealership. But maybe for new VW and Mazda cars we could offer a free autocross entry and work with Thayer to extend and increase their sponsorship to the autocross program? But in order for this idea to work, we need the Thayer sales folks educated about SCCA rally and autocross. And also how to get those interested Thayer customers in touch with SCCA folks so they can register.

Thanks, Jon.